

AG Power Supply Parts

AG

STK0065:
Transformer Replacement Kit with
Mounting Screws

STK0093:
AG Power Board Replacement Kit
Includes:
*CBP0004 Power Supply Assy
*ECP0123-SVC Fuse 2A,5x20mm,250VAC (Use for 110VAC)
*ECP0124-SVC Fuse 1A,5x20mm,250VAC (Use for 220VAC)
*15486 HDW Screw #6-32 X 5/16
*STK0095 Wire and Cable Replacement Kit

APK0042:
AG Flow Switch
Assy

STK0094:
Display PC Board Replacement Kit
Includes:
*846-2 Display Board for AG
20011 Modular Cable Assy for AG

APS0008:
Fuse Assy for AG
Includes 2A Fuse
(ECP0123-SVC),
Holder, and Wires

ECP0123-SVC:
(Use for 110VAC),Fuse,
2A,5x20mm,250VAC
or
ECP0124-SVC:
(Use for 220VAC),Fuse,
1A,5x20mm,250VAC

Used on AGR
and AGN

APK0020:
Flow Switch Jumper
Cable Assy Kit
Included with AGR
Only

STK0092:
AG Cover Replacement Kit
Includes:
*PCP0150 Molded Cover for AG
*LBP0106 Label, AG Cover Control
*LBP0107 Label, AG Cover Top
*GKP0111 O-Ring for AG Cover
*GKP0013 O-Ring Cord 3.5mm
*15403 #6-32 x 3/4 Screw PPMS

STK0095:
Wire and Cable Replacement Kit
Includes:
*22AK1800522 Wire Assy 18AWG, UL 1007, Black
*22AR1800522 Wire Assy 18AWG, UL 1007 Red
*22AY1800522 Wire Assy 18AWG, UL 1007 Yellow
*22AW1800522 Wire Assy 18AWG, UL 1007 White
20011 Modular Cable Assy

*Cannot be ordered separately

AG

AG PLUMBING

Return Jet Manifold With Cell

APK0018:
Return Jet Adaptor for AG
Includes:
PLP0080 Street Elbow 1-1/2" MIPT X 2" Slip
312-C-SVC Union Half, 1.5" Slip/2" Spigot x MTU
*PCP0122 PVC Pipe, 1-1/2" ID x 2-3/8" Long

952-SVC:
Cell Cord 12 ft with 3 Pin
MATE-N-LOK Connector
or
952-24:
Cell Cord 24 ft

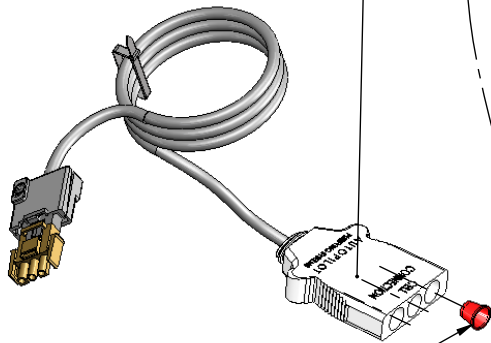

19050:
Red Protective Cap

APK0020:
Flow Switch Jumper Kit

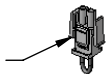

312-D:
Union Half, 2" Slip x Male Thread Union
(with O-Ring 19069-0)

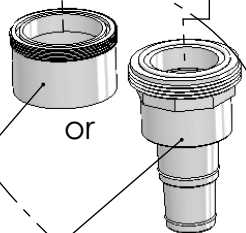

312-G:
Union Half, MT Union x Flex
(with O-Ring 19070-0)

APK0039:
Plumbing Package for Manifold
for Return Jet

Includes:
PLP0080 Street Elbow 1-1/2" MIPT X 2" Slip
312-G Union Half, Male Thread Union x 1.5"/1.25" Flex Hose
312-D Union Half, Male Thread Union x 2" Slip
312-C-SVC Union Half, 1.5" Slip/2" Spigot x Male Thread Union
*PCP0122 PVC Pipe, 1-1/2" ID x 2-3/8" Long

Return Jet Manifold
Included with AGR
Includes:
PPC1 PPC1 Replacement Cell
952-SVC Cell Cord
APK0039 Plumbing Pkg. for Manifold
APK0020 Flow Switch Jumper Kit

PPC1:
PPC1 Replacement Cell
with Female Unions

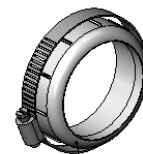

STK0048:
Cracked Union Nut
Service Kit

*Cannot be ordered separately

AGN PLUMBING

Inline Cell With Flow Switch

AG

Inline Cell
 Included with AGN
 Includes:
 PPC1 PPC1 Replacement Cell
 952-SVC Cell Cord
 APK0040 Plumbing Package for Manifold
 APA0019 Flow Switch Kit

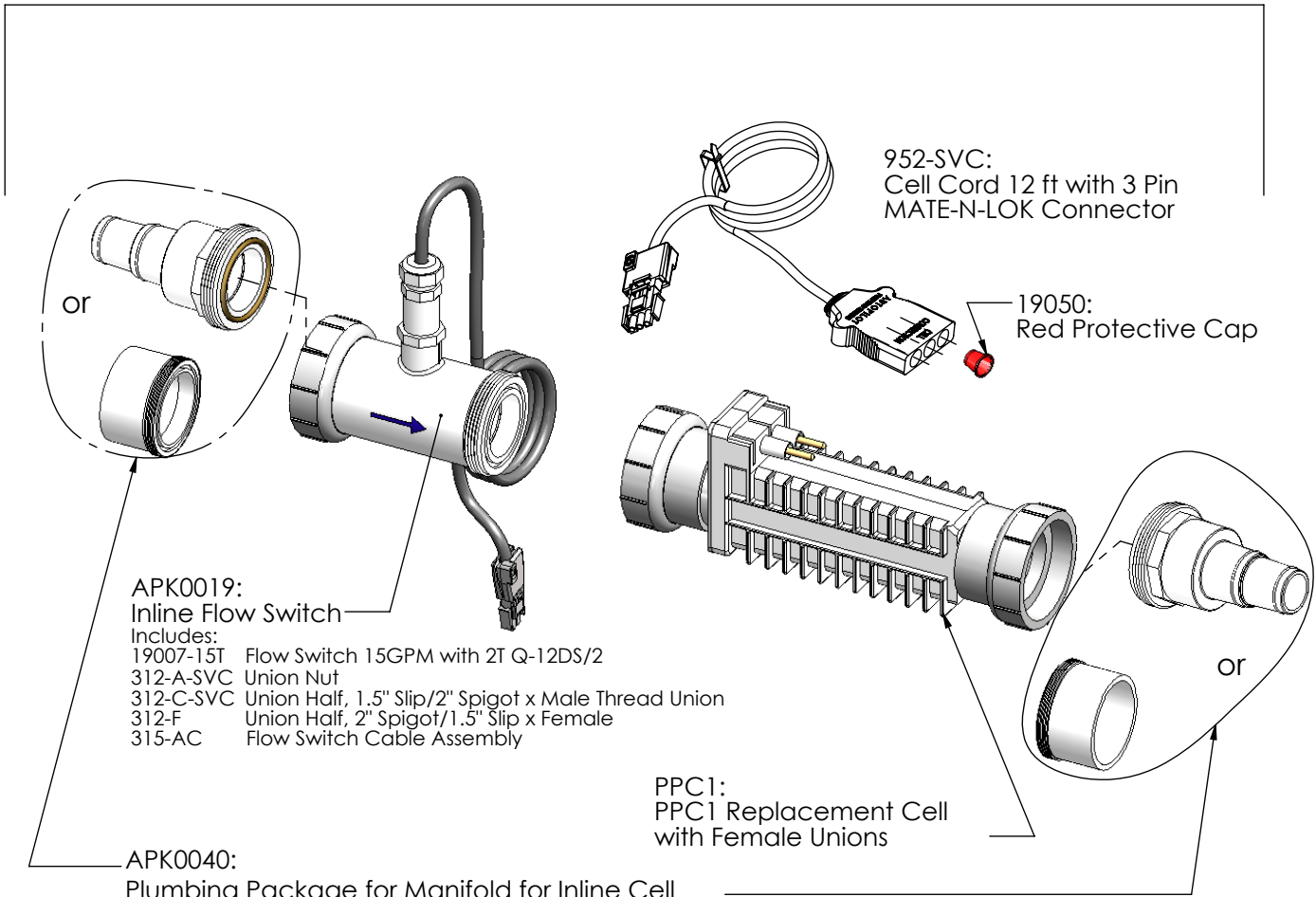

APK0019:
 Inline Flow Switch
 Includes:
 19007-15T Flow Switch 15GPM with 2T Q-12DS/2
 312-A-SVC Union Nut
 312-C-SVC Union Half, 1.5" Slip/2" Spigot x Male Thread Union
 312-F Union Half, 2" Spigot/1.5" Slip x Female
 315-AC Flow Switch Cable Assembly

APK0040:
 Plumbing Package for Manifold for Inline Cell
 Includes:
 312-G Union Half, Male Thread Union x 1.5"/1.25" Flex Hose (2)
 312-D Union Half, 2" Slip x Male Thread Union (with O-Ring) (2)

PPC1:
 PPC1 Replacement Cell
 with Female Unions

2576:
 Metric Adapter
 63mm ID Slip x 2" Spigot
 Quantity of 2 Needed
 Included in Metric Kits
 ONLY (Not Glued)

STK0048:
 Cracked Union Nut
 Service Kit